

TIMKEN**The Timken Company**

4500 Mt Pleasant St. NW

N. Canton, OH 44720

Phone: (234) 262-3000**E-Mail:** CustomerCAD@timken.com • **Web site:** www.timken.com**Part Number 7214 BTN1, Timken® Single Row Angular Contact Ball Bearings (7200, 7300)**

Timken® angular contact ball bearings are designed for combination radial and axial loading. Single-row bearings have high thrust capacity in one direction. Some single-row bearings are specifically designed for duplex mounting in sets for maximum performance.

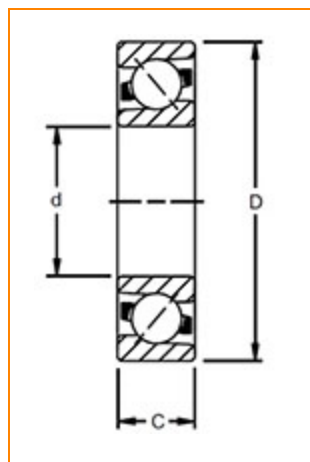

[Dimensions](#) | [Basic Load Ratings](#) | [Factors](#) | [Specifications](#) | [Abutment and Fillet Dimensions](#)

Dimensions

d - Bore	70.00 mm 2.7559 in
D - Outer Diameter	125.00 mm 4.9213 in
Bearing Width	24.00 mm 0.9449 in
Contact Angle	40 °

Basic Load Ratings

C0 - Static Radial Rating	58000 N 13034 lbf
----------------------------------	----------------------



40000 N

C1 ISO - Dynamic Radial Rating	87000 N 15507 lbf
--------------------------------	----------------------

Factors

Limiting Speed (Grease)	4900 rpm
Limiting Speed (Oil)	6500 rpm

Specifications

Ball Type	STEEL
Cage Type	Molded
Cage Material	Polyamide
Bearing Weight	1.11 Kg 2.447 lb
Design Units	METRIC
R - Inner Ring "Touch" Radius	0.6
r - Outer Ring "Touch" Radius	0.6
Features	Open

Abutment and Fillet Dimensions

R - Inner Ring "To Clear" Radius ¹	1.00 mm 0.039 in
r - Outer Ring "To Clear" Radius ²	1.00 mm 0.039 in
da - Inner Ring Backing Diameter	78.5 mm 3.091 in
Da - Outer Ring Backing Diameter	116.5 mm 4.587 in

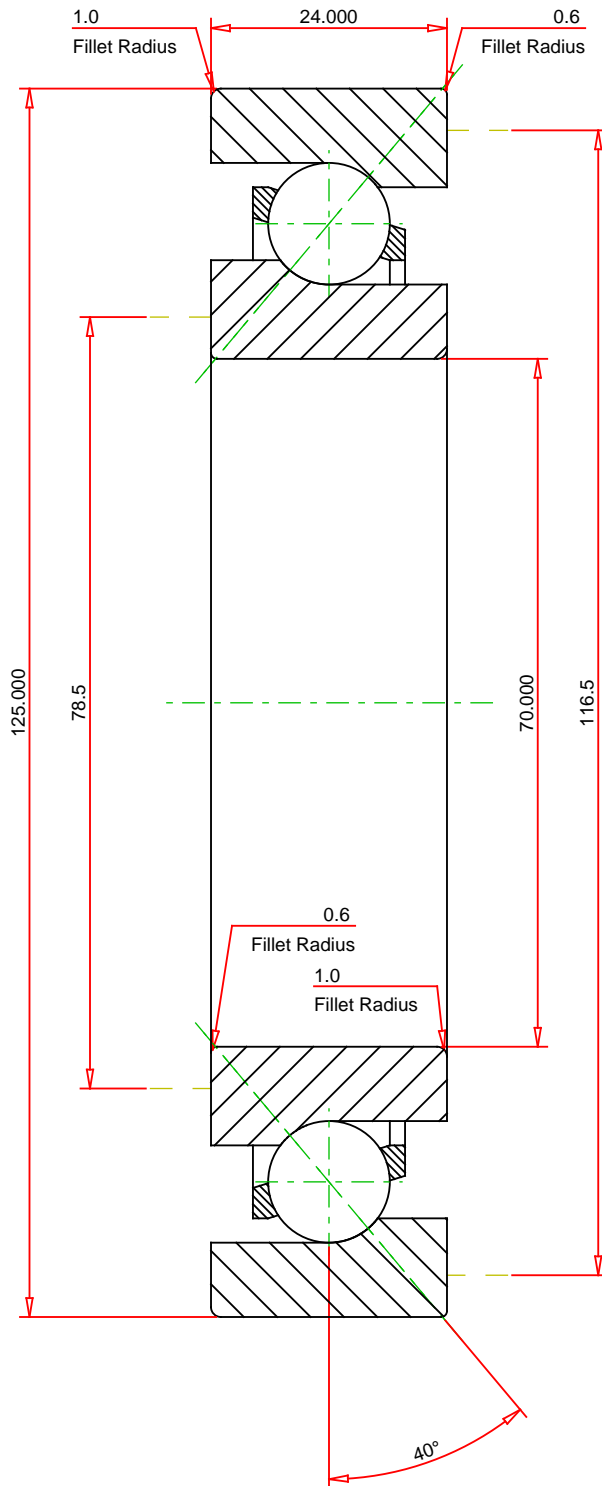

METRIC UNITS

Number of Balls Per Row	16
Bearing Weight	1.110 kg

TIMKEN®

THE TIMKEN COMPANY
NORTH CANTON, OHIO USA

7214 BTN1	
Timken® Single Row Angular Contact Ball Bearings (7200, 7300)	
Dynamic Radial Rating	69000 N
Static Radial Rating	58000 N

Every reasonable effort has been made to ensure the accuracy of the information contained in this writing, but no liability is accepted for errors, omissions or for any other reason.

FOR DISCUSSION ONLY